



**LP-Gas & Anhydrous Ammonia Equipment**

**H**

**Section H  
Adapters Connectors and Fittings**

# Limited Warranty and Limitation of Liability

## LIMITED 10 YEAR WARRANTY AND LIMITATION OF LIABILITY

### LIMITED 10 YEAR WARRANTY

REGO® warrants to the original purchasers the products and repair kits manufactured by it to be free from defects in materials and workmanship under normal use and service for a period of 10 years from the date of manufacture. If within thirty days after buyer's discovery of what buyer believes is a defect, buyer notifies in writing and ships the product to REGO® at 100 Rego Drive, Elon, NC 27244, REGO®, at its option, and within forty-five days of receipt, will repair, replace F.O.B. point of manufacture, or refund the purchase price of that part or product found by REGO® to be defective. Failure of buyer to give such written notice and ship the product within thirty days shall be deemed an absolute and unconditional waiver of any and all claims of buyer arising out of such defect.

This warranty does not extend to any product or part that is not installed and used continuously after installation in accordance with REGO®'s printed instructions, all applicable state and local regulations, and all applicable national standards, such as those promulgated by NFPA, DOT and ANSI. This warranty does not extend to any product or part that has been damaged by accident, misuse, abuse, failure to maintain, or neglect, nor does it extend to any product or part which has been modified, altered, disassembled, or repaired in the field. This warranty does not cover any cosmetic issues, such as scratches, dents, marring, fading of colors or discoloration.

Except as expressly set forth above, and subject to the limitation of liability below, REGO® MAKES NO OTHER WARRANTY, EXPRESS OR IMPLIED, INCLUDING, BUT NOT LIMITED TO, THE IMPLIED WARRANTIES OF MERCHANTABILITY AND FITNESS FOR A PARTICULAR PURPOSE, with respect to its products and parts, whether used alone or in combination with others. REGO® disclaims all warranties not stated herein.

### LIMITATION OF LIABILITY

REGO®'s total liability for any and all losses and damages arising out of any cause whatsoever shall in no event exceed the purchase price of the products or parts in respect of which such cause arises, whether such cause be based on theories of contract, negligence, strict liability, tort or otherwise.

REGO® shall not be liable for incidental, consequential or punitive damages or other losses. REGO® shall not be liable for, and buyer assumes any liability for, all personal injury and property damage connected with the handling, transportation, possession, further manufacture, other use or resale of products, whether used alone or in combination with any other products or materials.

From time to time buyers might call to ask REGO® for technical advice based upon limited facts disclosed to REGO®. If REGO® furnishes technical advice to buyer, whether or not at buyer's request, with respect to application, further manufacture or other use of the products and parts, REGO® shall not be liable for such technical advice or any such advice provided to buyer by any third party and buyer assumes all risks of such advice and the results thereof.

NOTE: Some states do not allow the exclusion or limitation of incidental, consequential or punitive damages, so the above limitation or exclusion may not apply to you. The warranty gives you specific legal rights, and you may have other rights that vary from State to State. The portions of this limited warranty and limitation of liability shall be considered severable and all portions which are not disallowed by applicable law shall remain in full force and effect.

### NOTICE TO USERS OF PRODUCTS

The Limited Warranty stated above is a factory warranty to the first purchasers of REGO® products. Since most users have purchased these products from REGO® distributors, the user must within thirty (30) days after the user's discovery of what user believes is a defect, notify in writing and return the product to the distributor from whom he purchased the product/part. The distributor may or may not at the distributor's option choose to submit the product/parts to REGO®, pursuant to this Limited Warranty. Failure by buyer to give such written notice within thirty (30) days shall be deemed an absolute and unconditional waiver of buyer's claim for such defects. Acceptance of any alleged defective product/parts by REGO®'s distributor for replacement or repairs under the terms of REGO®'s Limited Warranty in no way determines REGO®'s obligations under this Limited Warranty.

Because of a policy of continuous product improvement, REGO® reserves the right to change designs, materials or specifications without notice.

## Foreword

This catalog describes a complete line of equipment available from REGO® for use with LP-Gas and anhydrous ammonia (NH<sub>3</sub>). The following points are important to know for proper use of the catalog:

1. Illustrations and drawings of individual products are representative of “product groups” and all products within a product group are similar in construction.
2. Materials used for construction of products in this catalog are suitable for rated service pressure at temperatures of -40° F. to +165° F., unless otherwise specified.
3. Products in this catalog are only intended for use in LP-Gas and/or anhydrous ammonia service as follows.
  - a. “A” or “AA” prefix — Products with this prefix are suitable for NH<sub>3</sub> service (i.e., contain no brass parts).
  - b. “AA” prefix on relief valves — These valves are NOT suitable for use with LP-Gas service. These are of partial aluminum materials and are listed by Underwriters Laboratories (UL) for NH<sub>3</sub> service only.
  - c. All other products are suitable for use with LP-Gas service.
  - d. “SS” prefix—Hydrostatic relief valve with this prefix are suitable for NH<sub>3</sub> service (i.e., they have stainless steel materials).

### Caution

Do not use any product contained in this catalog with any service commodity other than LP-Gas or NH<sub>3</sub>. If you have a need for use of another application, contact REGO®, 100 RegO Drive, Elon, NC 27244, (336) 449-7707 before proceeding.

Proper application, installation and maintenance of products in this catalog are essential. Users of these products should obtain further information if there are any doubts or questions.

### Warning

All REGO® products are mechanical devices that will eventually become inoperative due to wear, corrosion and aging of components made of materials such as rubber. The environment and conditions of use will determine the safe service life of these products. Periodic inspection and maintenance are essential to avoid serious injury and property damage.

Many REGO® products are manufactured for storage, transport, transfer and use of toxic flammable and dangerous liquids and gases. Such substances should be handled by experienced and trained personnel only, using accepted governmental and industrial safety procedures. Never vent LP-Gas near any possible source of ignition.

### Notice

Installation, usage, and maintenance of all REGO® products must be in compliance with all REGO® instructions as well as requirements and provisions of NFPA #54, NFPA#58, DOT, ANSI, and all applicable federal, state, provincial and local standards, codes, regulations, and laws.

Inspection and maintenance on a periodic basis is essential. Installation and maintenance should be performed only by qualified personnel.

Be sure all instructions are read and understood before installation, operation and service.

### Filters

REGO® LP-Gas equipment is designed to operate in a system free from contamination. A variety of in-line filters are commercially available to the LP-Gas industry for installation in domestic systems.

The use of an in-line filter should be considered when other system components may be unclean and the system contaminated by rust, scale, dirt, debris or other foreign material.

## Contents

## Page

ACME Adapters.....	H9
ACME Check Connectors.....	H6
ACME Plugs.....	H7
Caps and Reducers.....	H8
Cross Reference by Part Number.....	H15
Extended Type Hose Couplings.....	H4
Filler Hose Adapters.....	H7
Miscellaneous Adapters.....	H10

Pigtails.....	H8
POL Adapters.....	H12
POL Plugs.....	H7
Pressure Gauge Adapter.....	H8
Short Type Hose Couplings.....	H5
Swivel Adapters.....	H12
Unloading Adapters.....	H6

# Extended Type Hose Couplings for Vapor and Liquid Service A7571 and A7575 Series

## Application

Designed especially for liquid filling and vapor equalization of LP-Gas and anhydrous ammonia. The limited travel of the handle on the tailpiece minimizes spin-off, encouraging cautious removal to properly bleed off trapped product to assure closure of the filler valve and hose end valve. The ACME threads are machined on a rugged steel insert which is permanently cast in the aluminum handle, providing for durability under repeated use.

## Features

- Lightweight aluminum handle is contoured and ribbed for added comfort, easy handling allows for easy make-up.
- Free swivel action between tailpiece and handle allows for easy make-up.
- Simplified design eliminates an extra joint and provides smooth, uninterrupted flow.

## Materials

Handle ..... Aluminium  
 ACME Threads ..... Steel Inlet  
 Restraining Ring ..... Stainless Steel

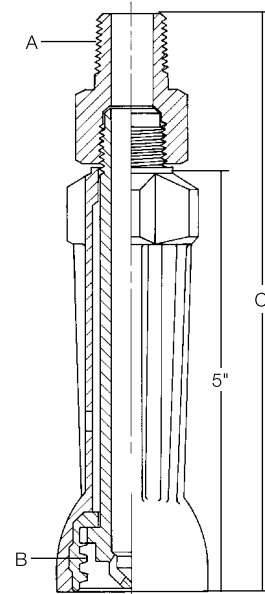

For Vapor Equalizing

A7571 Series

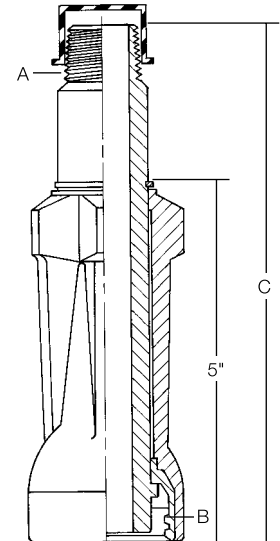

For Liquid Filling

A7575 Series



## Ordering Information

Part Number	Type of Service	A. Hose Connection (M. NPT)	B. Coupling Connection (F. ACME)	C. Approx. Length
A7575L2*	Liquid	1/2"	1 1/4"	7"
A7575L3		3/4"		
A7575L4		1"		
A7575L5**		1 1/4"		
A7571LA	Vapor	1/2"	1 1/4"	
A7571LB		3/4"		

\* Includes 7199-33 adapter, shipped loose.  
 \*\* Includes A7575L5-1 adapter, shipped loose.

# Short Type Hose Couplings for Vapor and Liquid Service 3171, 3175, 3181, 3185 and 3195 Series



3175 Series

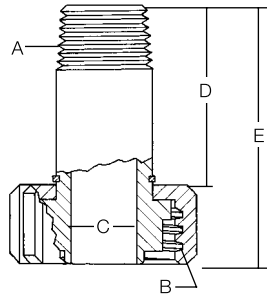

Style A  
For Liquid Filling



A3185 Series

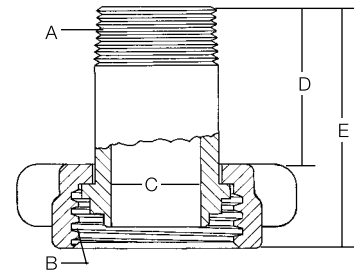

Style B  
For Liquid Filling



3171A Series

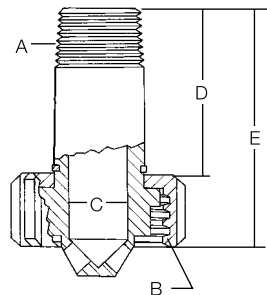

Style C  
For Vapor Equalizing



3191 Series

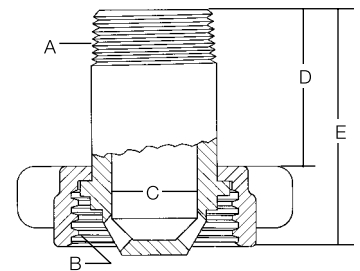

Style D  
For Vapor Equalizing



## Ordering Information

Part Number	Material	Style	A. Hose Connection (M. NPT)	B. Coupling Connection (F. ACME)	C. Tailpiece Bore	D. Hose End To Nut	E. Overall Length
3175B	Brass	A	1/2"	1 1/4"	35/64"	2"	2 7/8"
3175			3/4"		3/4"		
3175A			1"		3/4"		
3185	Brass Nut & Steel Nipple	B	1 1/4"	2 1/4"	1 1/16"	2 1/16"	3 3/8"
3195			2"	3 1/4"	1 13/16"	2 7/8"	3 5/8"
A3175	Steel	A	3/4"	1 1/4"	3/4"	2"	2 7/8"
A3175A			1"		3/4"		
A3185			1 1/4"		2 1/4"		
A3195		B	2"	3 1/4"	1 13/16"	2 7/8"	3 3/8"
3171	Brass	C	3/8"	1 1/4"	13/32"	1 1/16"	2 1/16"
3171A			1/2"		17/32"		
3181			3/4"	1 3/4"	1 1/16"	2"	3 1/4"
3181A			1"		15/16"	1 7/8"	3 1/8"
3191			1 1/4"		2 1/4"	3/16"	2 1/8"

# ACME Check Connectors for Lift Trucks 7141F and 7141M

## Application

These brass connectors are especially designed to join the carburetor fuel line to the service valve on lift truck cylinders. Sturdy, long lasting ACME threads allow quick, hand-tight assembly that provides for quick and simple cylinder replacement. Back checks automatically close in each connector when disconnected.

The 7141M couples directly to the service valve. An integral O-ring is designed to seal before the internal check opens, aiding in product loss prevention. A gasket at the ACME thread is a secondary seal when the connectors are tightened together. The connector fits RegO® lift truck cylinder filling adapters for fast, convenient filling.

The 7141F accepts fuel line adapter and couples directly to the 7141M. The O-ring seal in the 7141M is designed to seal before the internal check opens to allow product to pass through the connection. The knurled coupling eases threading and the ACME threads provide rapid effortless make-up, even against LP-Gas pressure.

NOTE: Refer to the "Cylinder and Service Valves" section of the L-500 catalog for additional information.

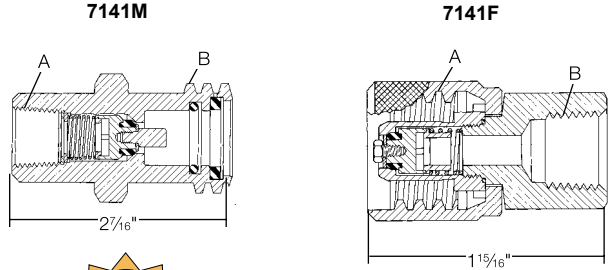

## Ordering Information

Part Number	Application	A. Inlet	B. Outlet	Protective Cap*	
				Rubber	Brass
7141M	Service Valve	3/8" F. NPT	1/4" M. ACME	7141M-40	7141FP
7141F	Fuel Line	1/4" F. ACME	1/4" F. NPT	-	-

\* Recommended to minimize foreign material entering valves which could result in leakage.

# Unloading Adapters for Container Evacuation 3119A and 3120

## Application

Designed to provide an efficient means of evacuating an LP-Gas container for relocation or repair. They thread directly onto the 1/4" ACME male hose connection of RegO® Filler Valves used on RegO® Double Check Filler Valves and Multivalves®.

The unloading adapters can be used to withdraw liquid provided the container is equipped with a dip pipe extending from the filler valve to the bottom of the container.

## Features

- Available in either angle or in-line type configurations.
- Built-in vent valve provides for a controlled release of gas which may be trapped within the unit after use and also helps to indicate closure of the Filler Valve.
- Integral plunger has two different lengths of travel, 1/4" and 1/2", depending on which way the lever is turned. Can be used with all RegO® Filler Valves.

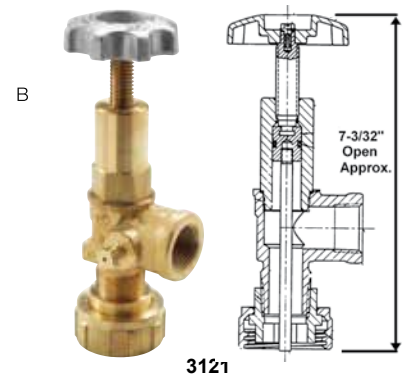
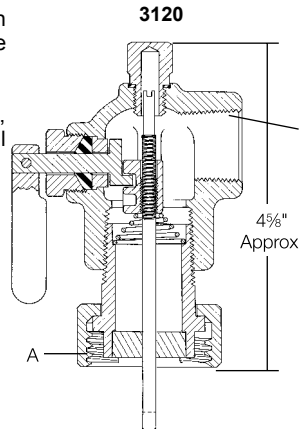
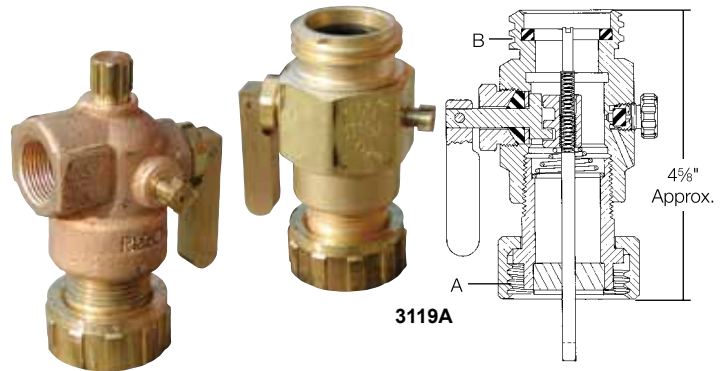

## Materials

Body ..... Brass  
Plunger ..... Steel

## Ordering Information

Part Number	Style	A. Filler Valve Connection	B. Hose Connection
3119A	In-Line	1 3/4" F. ACME	1/4" M. ACME
3120	Angle		3/4" F. NPT
3121			

## H6



## Filler Hose Adapters 3179B and 7577V

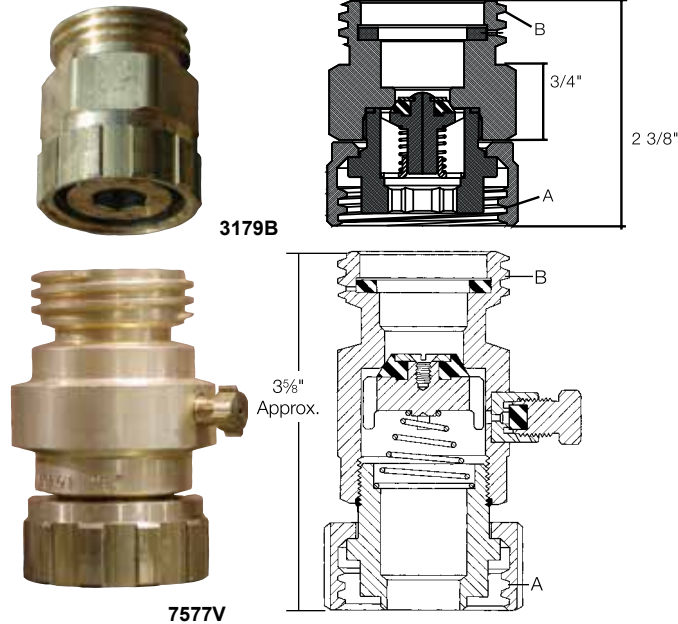

These adapters are designed with minimal flow restriction and recommended for use on the outlet of the LP-Gas delivery truck filler hose. If the controlled bleed off of the connection indicates the filler valve on the tank being filled has failed to close, the hose adapter should be left in place on the filler valve and disconnection should be made at the regular filler hose coupling. (Repair of the filler valve must be made as soon as possible). An integral check valve in these adapters helps prevent further loss of product. The standard filler valve cap should be attached to these adapters when left on the container.



### Ordering Information

Part Number	Built-in Vent Valve	A Filler Valve Connection	B Hose Connection
7577V	Yes	1 1/4" F. ACME	1 1/4" M. ACME
3179B	No		
7576	Yes		

## ACME Plugs

Specifically designed to withstand the everyday abuse given hose end valves on delivery trucks and hose end couplings on risers in bulk plants. These rugged plugs protect the coupling tip as well as prevent the entrance of dirt, dust, snow and rain. They also prevent possible gas contamination from these same sources. The heavily ribbed outer surface permits hand-tight make-up.

These plugs are available in a choice of four sizes which may be used with liquid as well as vapor type couplings. As a convenience, the nylon plugs have a retaining chain and ring to prevent loss during a transfer operation.

All are suitable for LPG or anhydrous ammonia service except the brass 5765PR, which is for LP-Gas only.

Not intended for use as pressure closures.



### Ordering Information

Part Number	Material	A (M. ACME)	Chain & Ring Fits Pipe Size Up To:
C5763N	Nylon	1 1/4"	3/4"
C5765N		1 1/2"	1 1/4"
5765PR	Brass	1 1/2"	Not Applicable
C5767N	Nylon	2 1/4"	1 1/4"
C5769N		3 1/4"	2"

## POL Plugs



**10538P**  
(Has hole for attaching wire to prevent loss of plug)

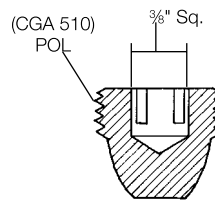

**3705RC**  
W/Chain & Ring

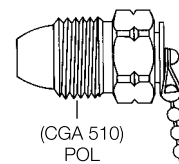

Highly recommended for installation in LP-Gas cylinder valve POL outlets whenever the service line is disconnected or when the cylinder is being transported.

When properly installed, the POL plug is designed to prevent contamination of the valve outlet and guards against product leakage if the cylinder valve is accidentally opened.

### Ordering Information

Part Number	Material	Connection
N970P	Cyclac	M. POL (CGA 510)
10538P	Brass	
3705RC		

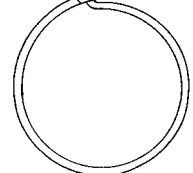

# Caps and Reducers

## Ordering Information

Cap With Chain & Ring				
Part Number	Ring Fits Pipe Size Up To:	Cap Only Part Number	Material	Thread Connection
3144-91	3/4"	3144-9P	Cyclac	1 1/4" F. ACME
3174-91		3174-9P		1 1/4" F. ACME
3174-93				1 1/4" F. ACME
A8016-93	1 1/4"	A8016-9P	Nylon	F. POL (CGA 510)
1708	3/4"	-	Brass	1 1/4" F. ACME
7141FP	1 1/4"			1 1/4" F. ACME
3175P				1 1/4" F. ACME
3184-90				2"
3194-90	3"			3194-9
-	-	5776*	Steel	2 1/4" F. ACME
A3184-90	2"	-		3 1/4" F. ACME
A3194-90	3"	-		1 1/16" F. ACME
-	-	A5776*	Brass	1 1/16" F. ACME
907FP	1"	-		1 1/16" F. ACME

\* Reduces to 1 1/4" M. ACME

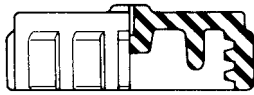

3144-91 Plastic Cap

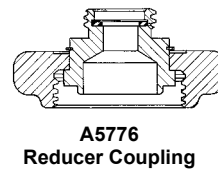

A5776 Reducer Coupling

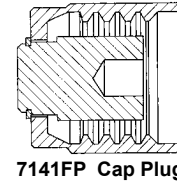

7141FP Cap Plug

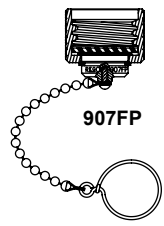

907FP

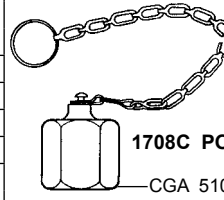

1708C POL Cap

CGA 510



3194-90G ACME Cap with Stainless Steel Flange

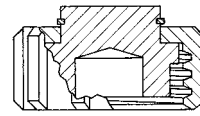

3175P Cap Plug

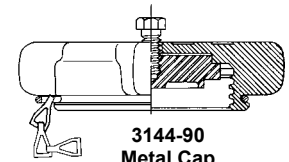

3144-90 Metal Cap

## Copper Pigtails

### Features

- Heavy duty construction.
- Individually soldered connections to the copper tubing.
- Each pigtail is individually tested prior to shipment.



### Materials

Tubing..... Copper  
Connections..... Brass

912JS12



### Straight Pigtails

## Ordering Information

Connections	Approximate Length	Part Number		
		1/4" Tube		3/8" Tube
		7/8" Hex Short Nipple	1 1/8" Hex Long Nipple	7/8" Hex Short Nipple
M.POL x M.POL	5"	-	1/2"	913JS05
	12"	912PS12	-	913PS12
	20"	912PS20	912PA20	913PS20
	30"	912PS30	-	913PS30
	36"	912PS36	912PA36	913PS36
1/4" Inverted Flare x M.POL	48"	912PS48	912PA48	913PS48
	12"	912FS12	-	-
	20"	912FS20	912FA20	-
	30"	912FS30	-	-
1/4" M.NPT x M.POL	36"	912FS36	-	-
	5"	-	-	913JS05
	12"	912JS12	-	-
1/2" M.NPT x M.POL	20"	912JS20	-	-
	36"	912JS36	-	-
1/2" M.NPT x M.POL	12"	-	-	913LS12
1/2" M.NPT x 3/8" M.POL	12"	-	-	913KL12

612J Series Gauge Tail

1/4" NPT

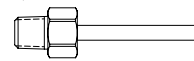

0-300 PSIG Pressure Gauge

POL (CGA 510)

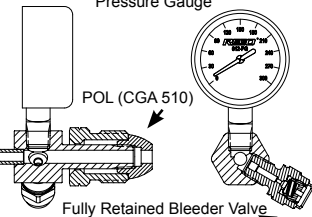

Fully Retained Bleeder Valve Flat Blade Screw Slot

612P Series Gauge Tail

POL (CGA 510)

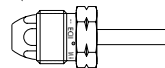

0-300 PSIG Pressure Gauge

POL (CGA 510)

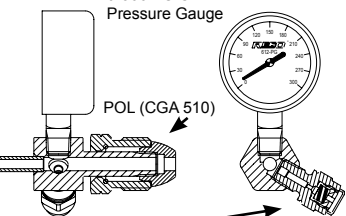

Fully Retained Bleeder Valve Flat Blade Screw Slot

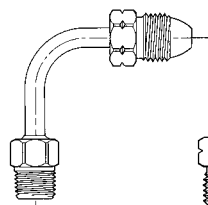

913JS05A

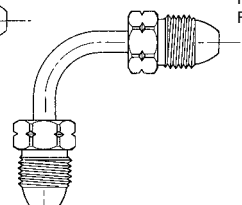

913PS05A

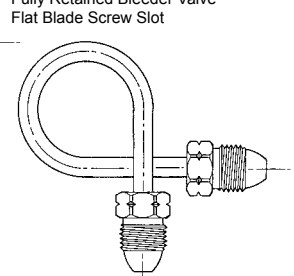

913PS12G

### Bent Pigtails

## Ordering Information

Connections	Approximate Length	Part Number		Type/Degree of Bend
		3/8" Tube	7/8" Hex Short Nipple	
1/4" M. NPT x M. POL	5"	913JS05A	-	90°
		913PS05A	-	
M. POL x M. POL	12"	913PS12G	-	270° Right Hand
		913PS12H	-	270° Left Hand
		913PS12S	-	360°



# ACME Adapters

## Ordering Information

Part Number	Material	A M. ACME	B F. NPT	C Hex	D Overall Length	E Diameter	For Spare Gasket Order Part No.	
5764A	Brass	1 3/4"	1/4"	1 3/4"	1 1/2"	3/4"	A2697-20R	
5764B			3/8"		1 1/8"			
5764C			1/2"		1 1/4"			
5764D			3/4"		1 3/8"			
5764E			1"		1 1/2"			
5766E		2 1/4"	1"	2 1/4"	2 5/16"	1 3/8"		A3184-8R
5766F			1 1/4"		2 1/8"			
5768G			1 1/2"		2 3/8"			
5768H		3 1/4"	2"	3 1/2"	3 5/8"	2 1/8"		A3194-8R
5768J			2 1/2"		3 1/4"			
A5764D	3/4"		1 3/4"		2 3/8"		3/4"	A2697-20R
A5764E	1"	A3194-8R						
A5768H	3 1/4"	2"		3 1/4"		1 13/16"		

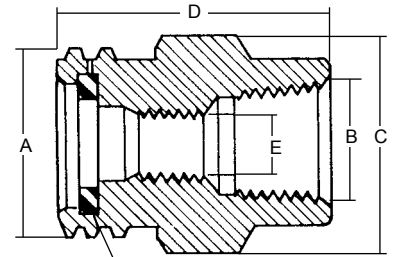

Gasket (Furnished with adapter)

**ACME x Female NPT**

## Ordering Information

Part Number	Material	A M. ACME	B M. NPT	C Hex	D Overall Length	E Diameter	For Spare Gasket Order Part No.	
5763D	Brass	1 1/4"	3/4"	1 1/4"	1 3/4"	7/16"	A2797-20R	
5765D			3/4"		1 1/8"	2 1/8"	1 1/16"	A2697-20R
5765E			1"		1 1/4"			
5765F		2 1/4"	1 1/4"	2 1/4"	2 5/16"	1 3/16"	A3184-8R	
5767F			1 1/2"		1 3/8"			
5767H			2"		2 3/8"	2 7/8"		1 25/64"
5769H		3 1/4"	2"	3 3/8"	3 1/2"	2 7/8"	1 7/8"	A3194-8R
5769J			2 1/2"	3 1/4"		2 1/8"		
5769K			3"	3 1/2"		3 5/8"		
A5765C		Steel	1 1/4"	1/2"	1 3/4"	2 3/16"	1 7/32"	A2697-20R
A5765D	3/4"			1 1/16"				
A5765E	1"			7/8"				
A5765F	1 1/4"			1 5/16"				
A5767F	2 1/4"		1 1/4"	2 1/4"	2 3/8"	1 3/16"	A3184-8R	
A5769H	3 1/4"		2"	3 1/4"	2 1/4"	1 7/8"	A3194-8R	
A5769K			3"		3 1/16"	2 1/8"		

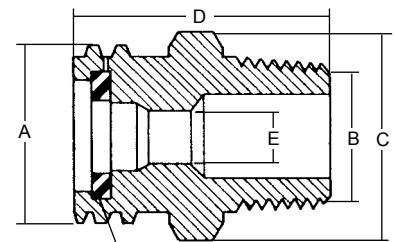

Gasket (Furnished with adapter)

**ACME x Male NPT**

## Ordering Information

Part Number	Material	A M. ACME	B Hex	C	D Diameter	For Spare Gasket Order Part No.
5765M	Brass	1 1/4"	1 1/4"	2 1/16"	7/8"	A2697-20R
5767M		2 1/4"	2 1/4"	2 5/16"	1 25/64"	A3184-8R
5769M		3 1/4"	3 1/4"	2 3/4"	2 1/8"	A3194-8R

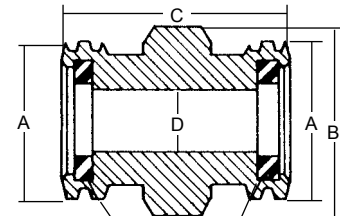

Gasket (Furnished with adapter)

**ACME x ACME**

## Ordering Information

Part Number	Material	A M. ACME	B F. NPT	C Hex	D Diameter	For Spare Gasket Order Part No.
A5764W	Steel	1 1/4"	3/8"	1 1/4"	1 11/16"	2697-20
5764W	Brass					

\* 3/8" -16 UNC Thread.

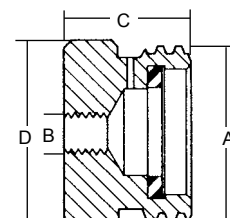

**ACME x Miscellaneous**  
(Recommended for securing hose-end valve when not in use).

# 3 1/4" M.ACME X 2" M.NPT Adapter with Vent Valve & Integral Screen 5769HVB

## Application

Designed to prevent debris from impeding the action of valves and components of LPG piping systems at bulk plants and industrial plants.

## Features

- Meets NFPA 58 requirements for liquid transfer
- Stainless steel screens
- Vent valve available in brass or stainless steel



5769HVB

## Materials

Body ..... Brass  
 Screen ..... Stainless Steel  
 Gasket ..... Resilient Rubber

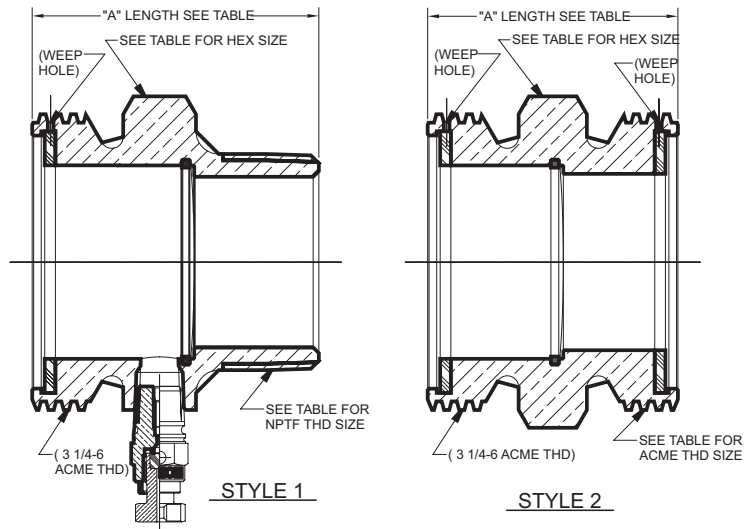

## Ordering Information

Part Number	Style	Gasket Qty	Vent Valve	Hex Size	Thread	"A" Length
5769H	1	1	-	3 1/4"	2" NPTF	2.875
5769K	1	1		3 1/2"	3" NPTF	3.625
5769M	2	2		3 1/4" ACME	2.750	
5769HVB	1	1	3165CBT	3 1/4"	2" NPTF	3.150
5769VSS	1	1	TSS3169			3.150

# Low Emission ACME Connector For Transports and Bobtails 6588LE & 6589LE

## Application

Designed to provide fast filling of bobtails, transports and large bulk storage tanks while providing for low emission of LPG when disconnecting.

## Features

- 3/4" Male Acme Connector with reduced emissions, 90% less than current ECII ACME adapters.
- 10.5 cubic centimeters of liquid discharged at disconnect
- UL Listed as a Filler Valve.
- Safety groove is designed to shear below ACME threads leaving the valve seat closed and unaffected if the vehicle pulls away with the hose connected.
- Seat disc is made of synthetic composition and is mechanically held in place by a seat disc retainer.
- Stainless Steel return spring.
- One- piece poppet stem for smooth operation.
- Will connect to any standard female 3/4" ACME adapter.
- Hydrostatic relief valve included (3125L).

## Materials

Upper Body.....	Brass
Lower Body.....	Brass
Poppet & Stem Assembly.....	Brass
Spring.....	Stainless Steel
Gasket.....	Resilient Synthetic Rubber
Seat Disc.....	Resilient Synthetic Rubber

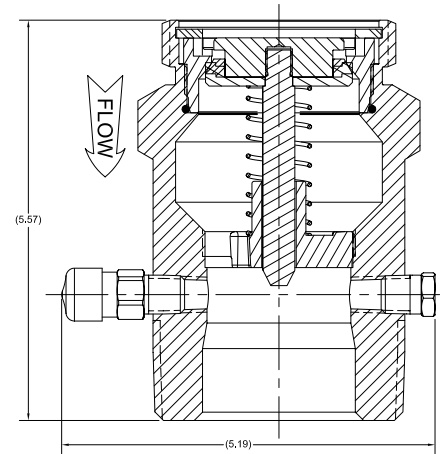

6588 Series

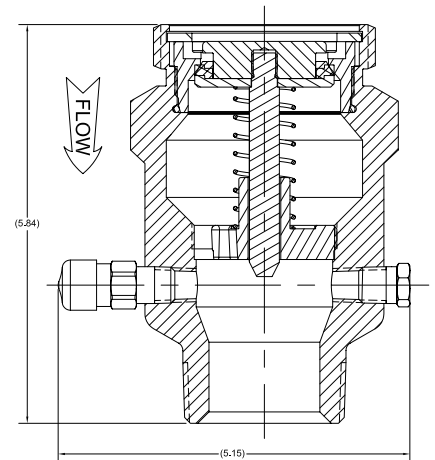

6588 Series

## Ordering Information

Part Number	ACME Connection	Outlet Connection M.NPT	Wrench Flats	Hydrostatic Relief Valve	Propane Capacity at Various Differential Pressures (GPM)		
					5 PSIG	10 PSIG	25 PSIG
6588LE	3/4"	2"	3"	3125L	138	223	349
6589LE	3/4"	3"	3 1/4"	3125L			

# Male POL Swivel Adapters

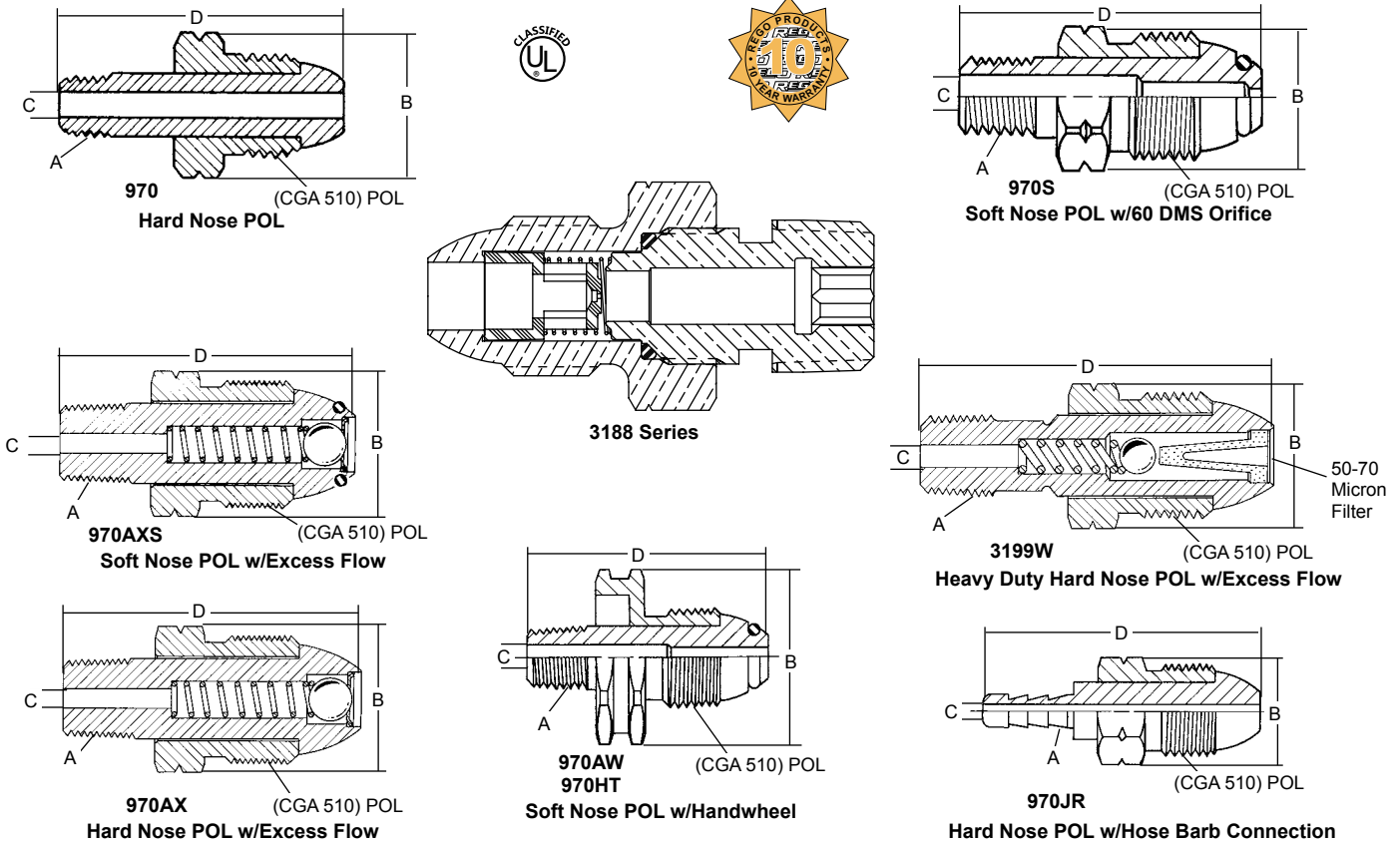

## Ordering Information

Part Number	Material	A Outlet Thread	B Hex	C Drill	D Overall Length	Vapor at 100 PSIG Inlet (SCFH)	Liquid (GPM)		
970	Brass	1/4" M. NPT	7/8"	5/16"	2 3/8"	-	-		
970S				3/16"	2 3/32"				
970AX				5/16"	2 5/64"			404	1.10
970AXS			1 3/8"	2 7/16"	450			0.95	
3199W				3/16"	2 3/32"			-	-
970AW				5/32"	2 5/8"				
970HT		5/16"	2 1/2"						
970JR		1/4" Hose Barb	7/8"	5/32"	2 5/8"	-	-		
3188A		1/2" M. NPT	1 1/8"	5/16"	2 1/2"	350	.95		
3188B						700	1.9		
3188C	1180					2.9			

Note: All nipples incorporate wrench hex section.

# CGA 555 Swivel Adapters

Part Number	Material	A Outlet Thread	B Hex	C Drill	D Overall Length
12982	Brass	1/4" M. NPT	1 1/4"	3/16"	1 15/16"
12982G		3/16" -18NF			

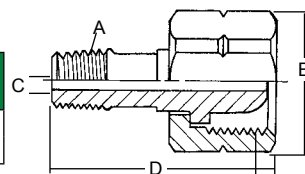

CGA 555



# POL Adapters

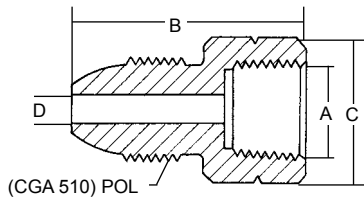

Male POL x Female NPT

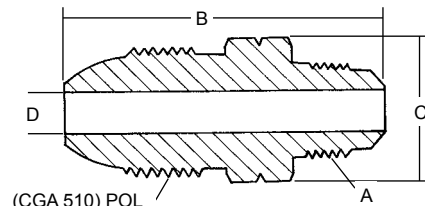

Male POL x Male NPT and SAE Flare

## Ordering Information

Part Number	Material	A M. ACME	B	C Hex	D Diameter
2906A	Brass	1/4"	1 3/8"	1 5/16"	1/4"
2906G		1/2"	2"	1 1/8"	

## Ordering Information

Part Number	Material	A	B	C Hex	D Diameter
2906D	Brass	3/8" M. NPT	2 1/16"	1 5/16"	1 1/32"
2906F		3/8" SAE Flare			
2906E		1/2" SAE Flare	2 1/4"	7/8"	9/32"

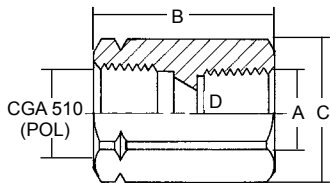

Female POL x Female NPT and Female POL

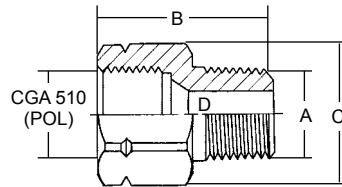

Female POL x Male NPT

## Ordering Information

Part Number	Material	A	B	C Hex	D Diameter
5760Z	Brass	1/8"	1 5/8"	1 1/8"	5/16"
5760A		1/4"			13/32"
5760B		3/8"			35/64"
5760C		1/2"			43/64"
5760D		3/4"			13/32"
5760S	POL (CGA 510)	2 1/8"	1 1/8"		

## Ordering Information

Part Number	Material	A	B	C Hex	D Diameter
5761A	Brass	1/4"	1 5/8"	1 1/8"	3/16"
5761B		3/8"			13/32"
5761C		1/2"			7/16"
5761D		3/4"			

Hose Adapter  
For use with fuel gases (LP-Gas, Acetylene).

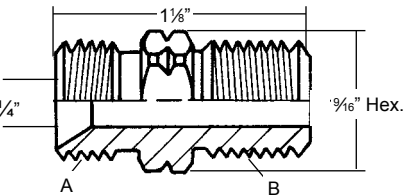

## Ordering Information

Part Number	Material	A	B
1300	Brass	9/16" - 18NF (L.H.)	1/4" M. NPT

Pressure Gauge Adapter

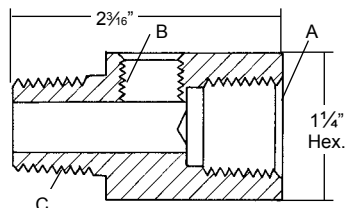

## Ordering Information

Part Number	Material	A	B	C
1494-1	Brass	1/2" F. NPT	1/4" F. NPT	1/2" M. NPT

## Ordering Information

Part Number	Material	A	B
15774-1	Brass	1/4" M. NPT	Female Inverted Flare

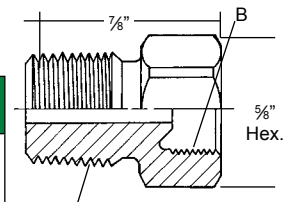

Female Inverted Flare x Male NPT

## Ordering Information

Part Number	Material	A	B	C	D	E	F
1328	Brass	5/8" - 18 UNF	5/8" - 18 UNF	1/4" Hose Barb	13/16"	2"	1 1/2"
1331		3/4" - 16 UNF	3/4" - 16 UNF		1 1/16"		
1332		7/8" - 14 UNF	7/8" - 14 UNF		1 1/16"		

# Hose End Valve Adapter 7576

## Application

No gas flow is allowed when this adapter is not connected to the 1¼" ACME connection of a filler valve, it also acts as a back check.

## Features

- Designed to be installed on the outlet connection of LP-Gas hose end valve; no flow is allowed until the 7576 adapter female ACME connection is engaged on to the male ACME threads on the filler valve.
- Incorporates a back check that will stop flow out of a filler valve that fails to close, when the 7576 adapter remains connected to the filler valve.
- Bleeder valve is designed to vent gas between the hose end valve connection and 7576 hose end adapter.
- Long grip ACME swivel for ease in connecting and disconnecting from a filler valve connection.



7576

## Materials

Body .....	Brass
Inlet Connection.....	Brass
Outlet Connection.....	Brass
ACME Swivel.....	Aluminum
Spring .....	Stainless Steel
Seat Disc .....	Synthetic Rubber
O-Rings .....	Synthetic Rubber

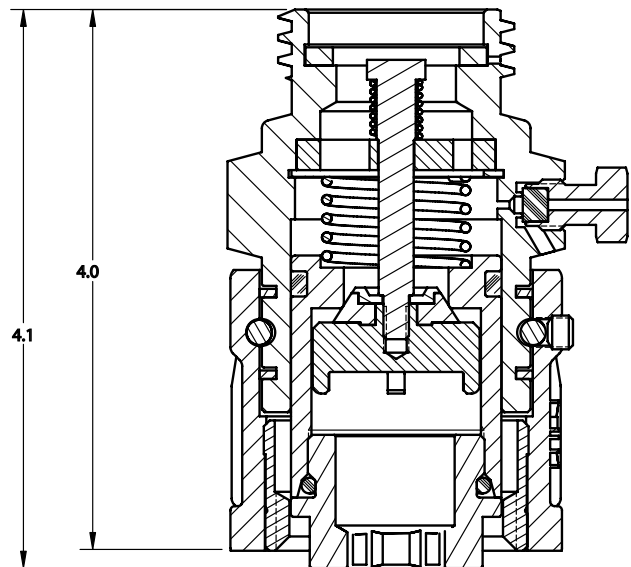

## Ordering Information

Part Number	Vent Valve	Filler Connection	Hose End Valve Connection	Propane Liquid Capacity @ 80 PSID
7576	Yes	1¼" F. ACME	1¼" M. ACME	57 GPM



## Cross Reference by Part Number

907FP.....	H8	3705RC.....	H7
912FS12.....	H8	5760A.....	H13
912JS12.....	H8	5760B.....	H13
912PS12.....	H8	5760C.....	H13
912FA20.....	H8	5760D.....	H13
912FS20.....	H8	5760S.....	H13
912JS20.....	H8	5760Z.....	H13
912PA20.....	H8	5761A.....	H13
912PS20.....	H8	5761B.....	H13
912FS30.....	H8	5761C.....	H13
912PS30.....	H8	5761D.....	H13
912FS36.....	H8	5763D.....	H9
912JS36.....	H8	C5763N.....	H7
912PA36.....	H8	5764A.....	H9
912PS36.....	H8	5764B.....	H9
912PA48.....	H8	5764C.....	H9
912PS48.....	H8	5764D.....	H9
913JS05A.....	H8	5764E.....	H9
913PS05A.....	H8	A5764D.....	H9
913PS12G.....	H8	A5764E.....	H9
913PS12H.....	H8	A5764W.....	H9
913PS12S.....	H8	5765D.....	H9
970AW.....	H12	5765E.....	H9
970AX.....	H12	5765F.....	H9
970AXS.....	H12	5765M.....	H9
970HT.....	H12	5765PR.....	H7
970JR.....	H12	A5765C.....	H9
970S.....	H12	A5765D.....	H9
N970P.....	H7	A5765E.....	H9
1300.....	H13	A5765F.....	H9
1328.....	H13	C5765N.....	H7
1331.....	H13	5766E.....	H9
1332.....	H13	5766F.....	H9
1494-1.....	H13	5767F.....	H9
1708.....	H8	5767G.....	H9
2906A.....	H13	5767H.....	H9
2906D.....	H13	5767M.....	H9
2906E.....	H13	A5767F.....	H9
2906F.....	H13	C5767N.....	H7
2906G.....	H13	5768G.....	H9
3119A.....	H6	5768H.....	H9
3120.....	H6	5768J.....	H9
3121.....	H6	A5768H.....	H9
3144-9P.....	H8	5769H.....	H9
3144-91.....	H8	5769H.....	H10
3171.....	H5	5769HVB.....	H10
3171A.....	H5	5769J.....	H9
3174-9P.....	H8	5769K.....	H9
3174-91.....	H8	5769K.....	H10
3174-93.....	H8	5769M.....	H9
3175.....	H5	5769M.....	H10
3175A.....	H5	5769VSS.....	H10
3175B.....	H5	A5769H.....	H9
3175P.....	H8	A5769K.....	H9
A3175.....	H5	C5769N.....	H7
A3175A.....	H5	5776.....	H8
3179B.....	H7	A5776.....	H8
3181.....	H5	7141FP.....	H8
3181A.....	H5	A7571LA.....	H4
3184-90.....	H8	A7571LB.....	H4
A3184-90.....	H8	A7575L2.....	H4
3185.....	H5	A7575L3.....	H4
A3185.....	H5	A7575L4.....	H4
3188A.....	H12	A7575L5.....	H4
3188B.....	H12	7576.....	H14
3188C.....	H12	7577V.....	H7
3191.....	H5	A8016-9P.....	H8
3194-9.....	H8	A8016-93.....	H8
3194-90.....	H8	10538P.....	H7
A3194-90.....	H8	12982.....	H12
3195.....	H5	12982G.....	H12
A3195.....	H5	15774-1.....	H13
3199W.....	H12		